

Open Web Device

Lock Screen

Release 1 // Sprint 4

Lock Screen

Security Flow

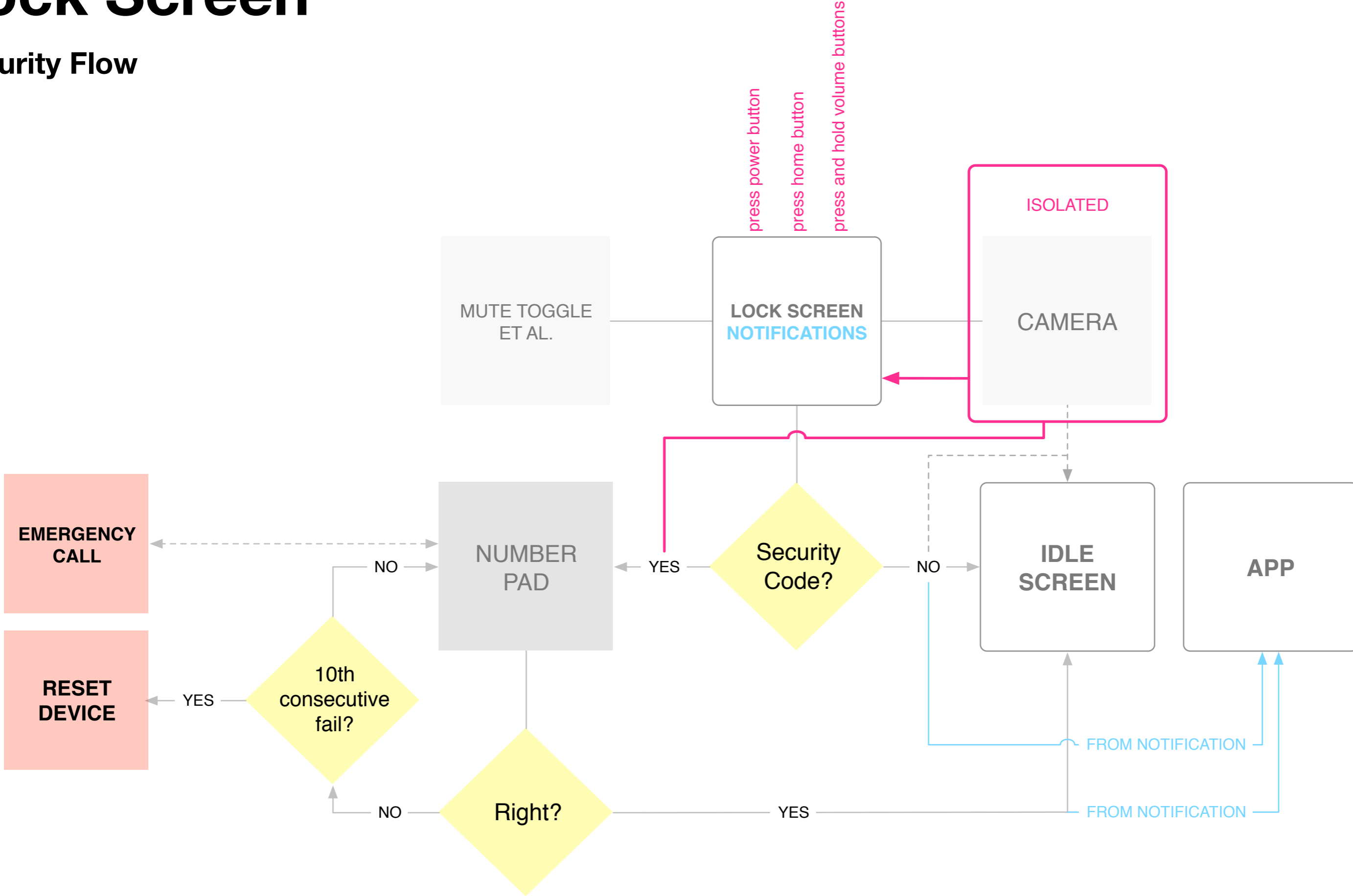

Lock Screen

Main Regions

A dedicated mute switch and camera shutter are both recommended

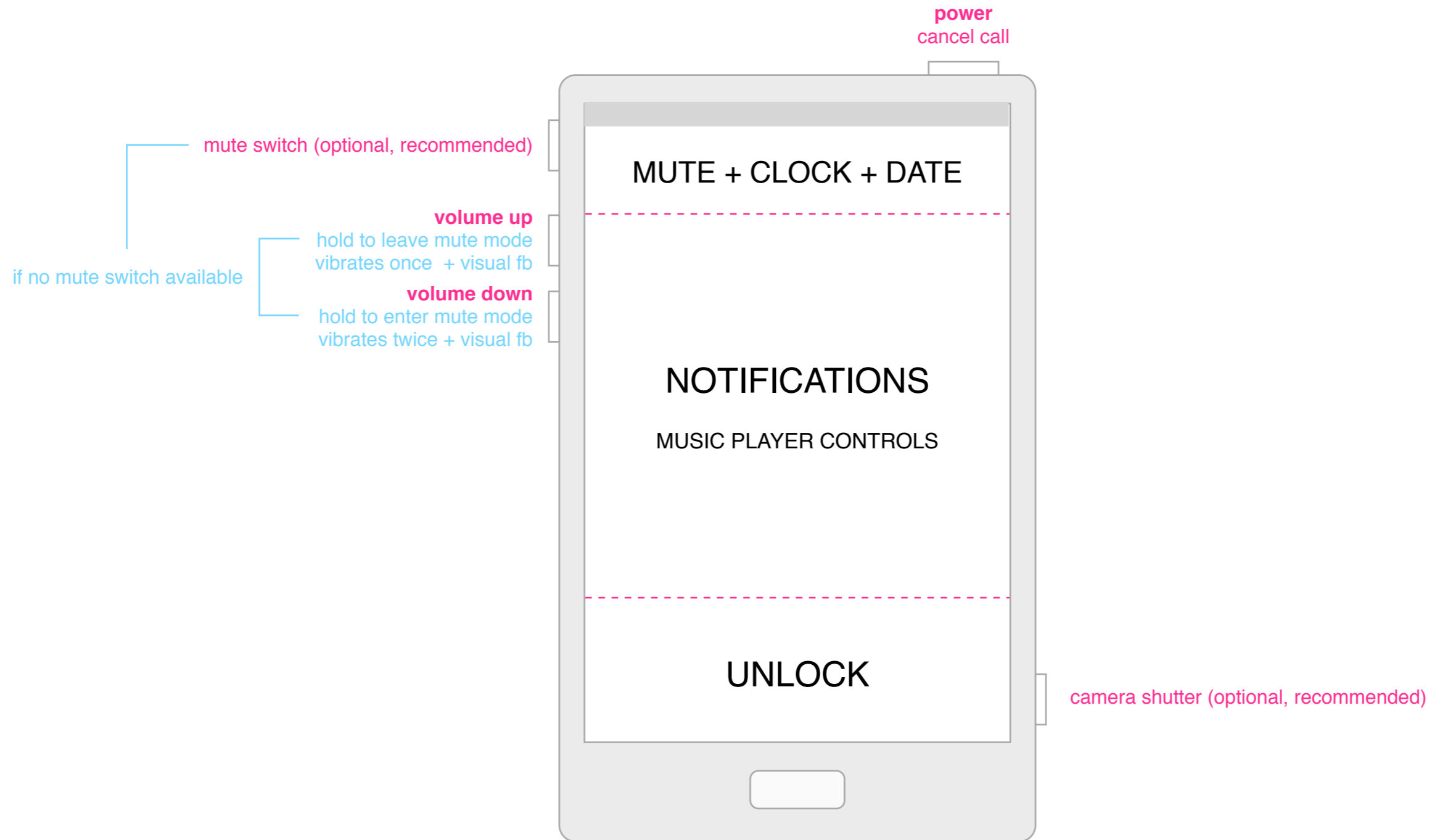

Lock Screen

Clock, Date, Info

The clock/date arrangement should be determined by the visual team, but the elements should prevail.

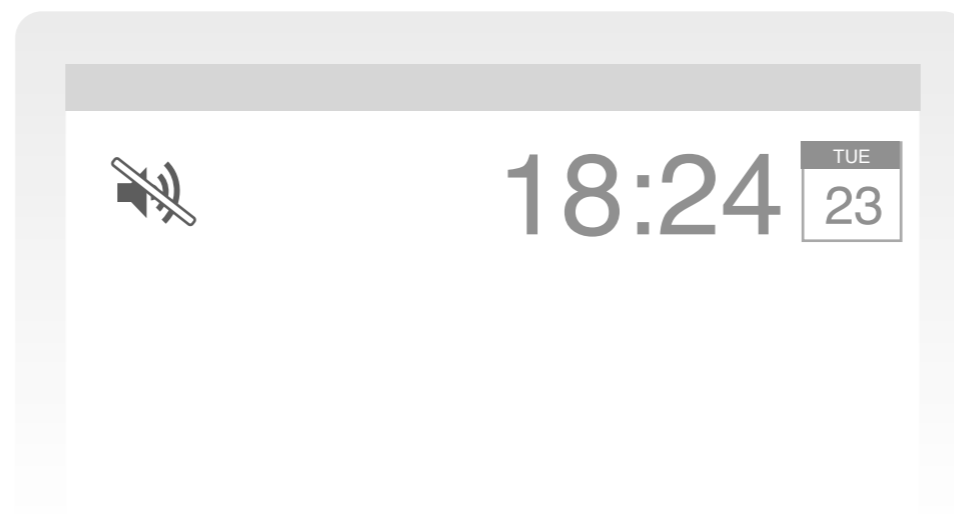

Lock Screen

Unlock Gestures

Different options depending on hardware button availability.

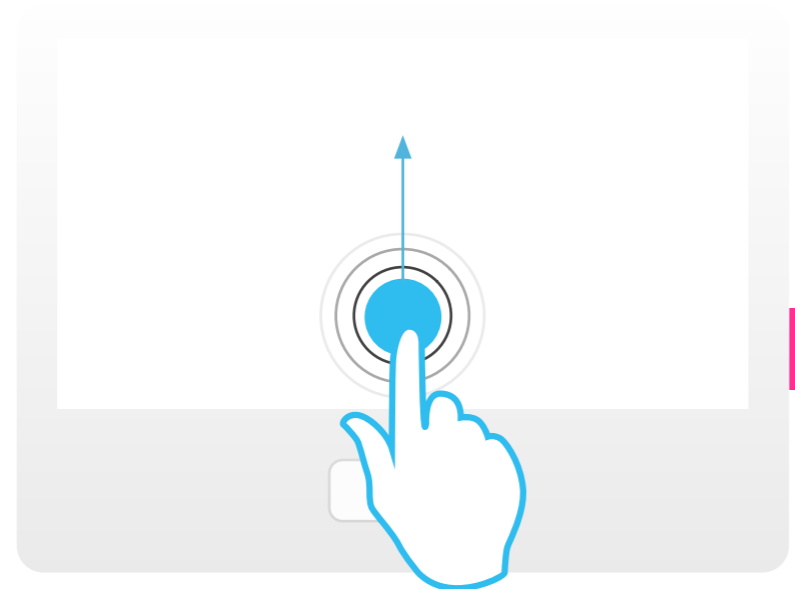

with hardware button for camera

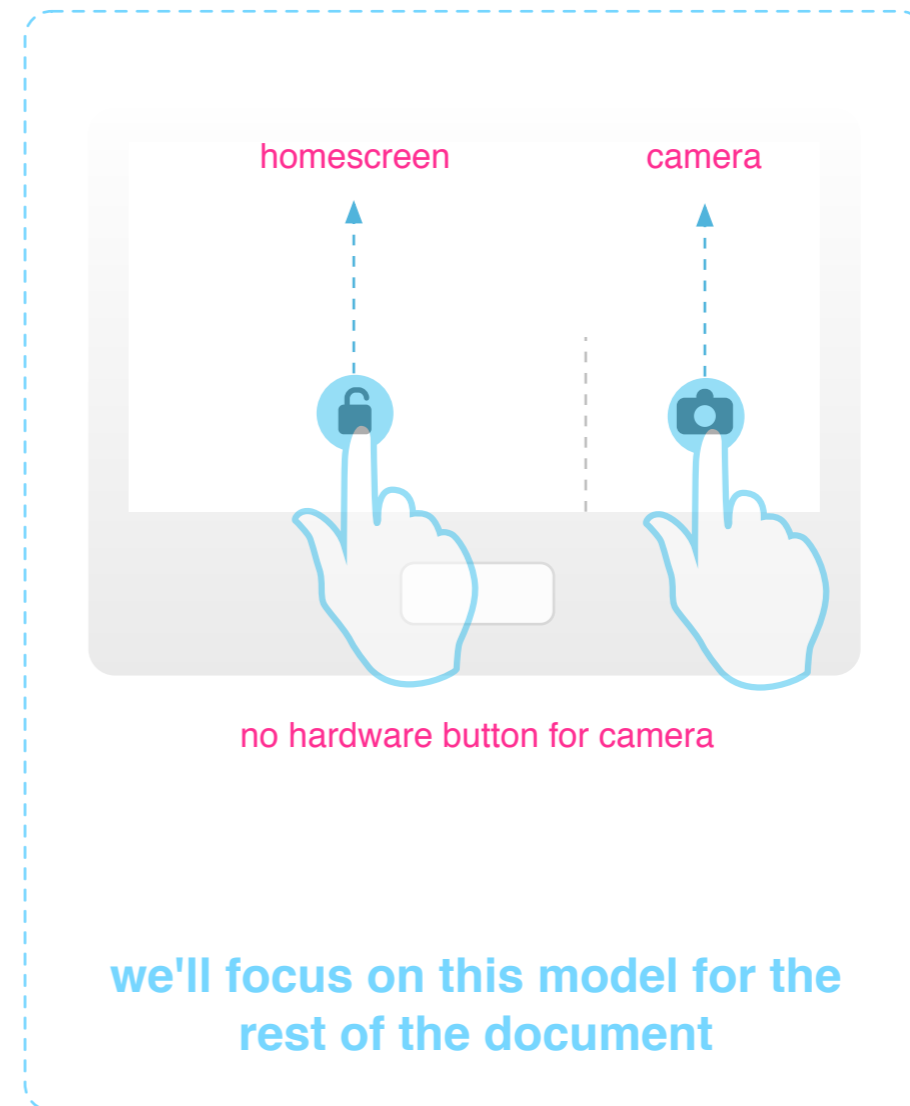

no hardware button for camera

we'll focus on this model for the rest of the document

Lock Screen

Hints

Tapping instead of dragging (or bouncing automatically in the case of incoming calls or alarms) will display hints hidden below the bottom of screen. Hints could be displayed on a per-case basis after being displayed a small number of times (even once), or maybe/additionally in Settings.

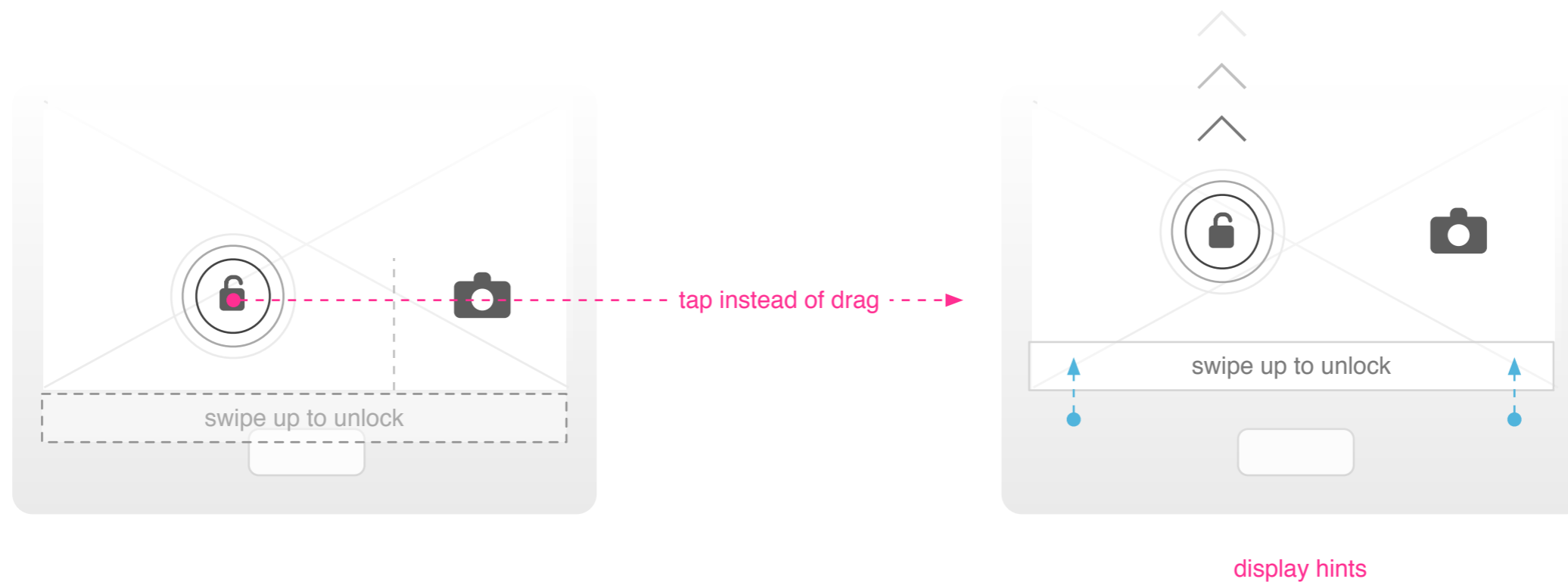

Lock Screen

Mental Map and Transitions

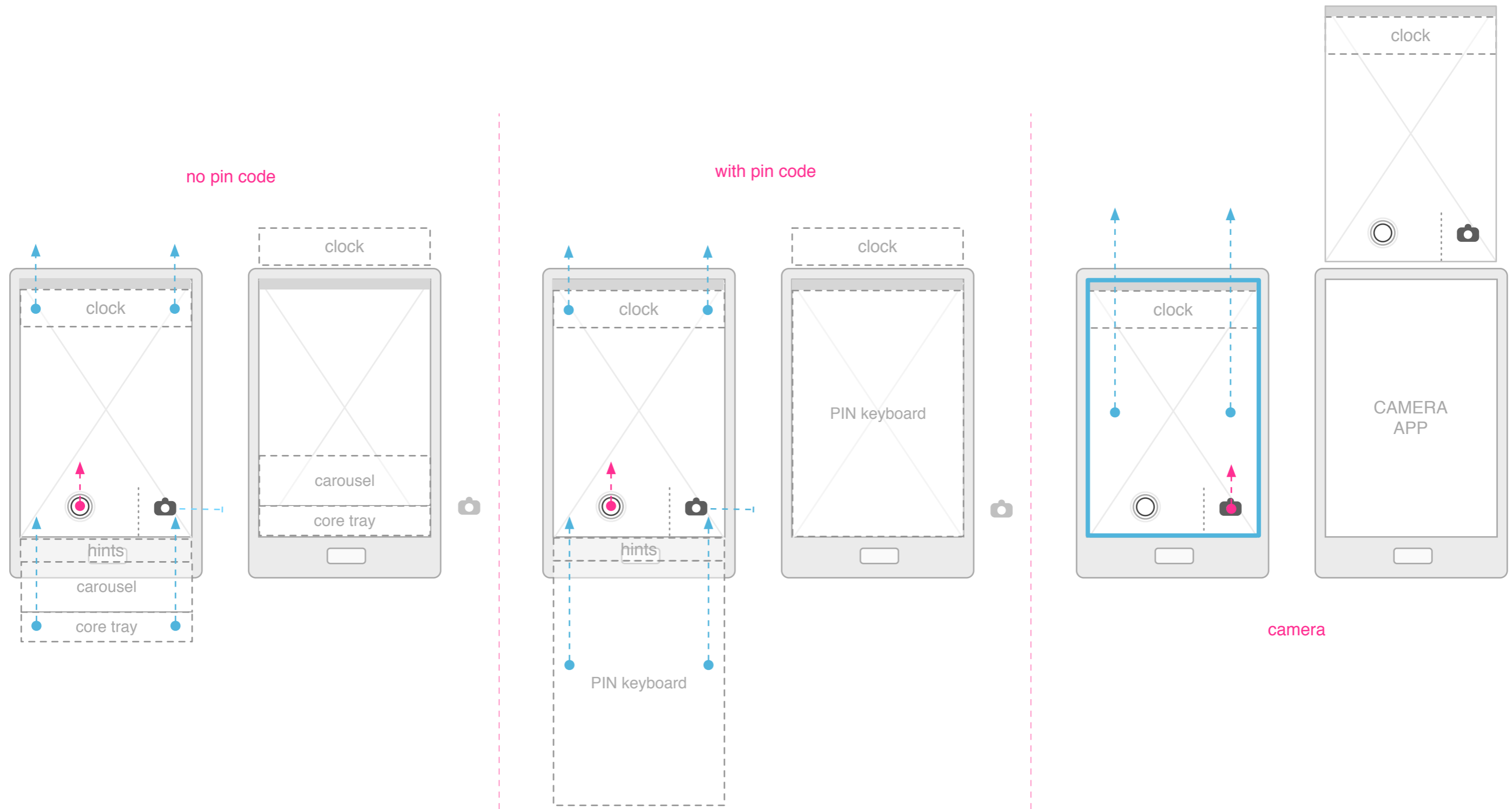

Lock Screen

Entering PIN Code

Consecutive attempts could be delayed if we're providing some sort of remote wiping functionality.

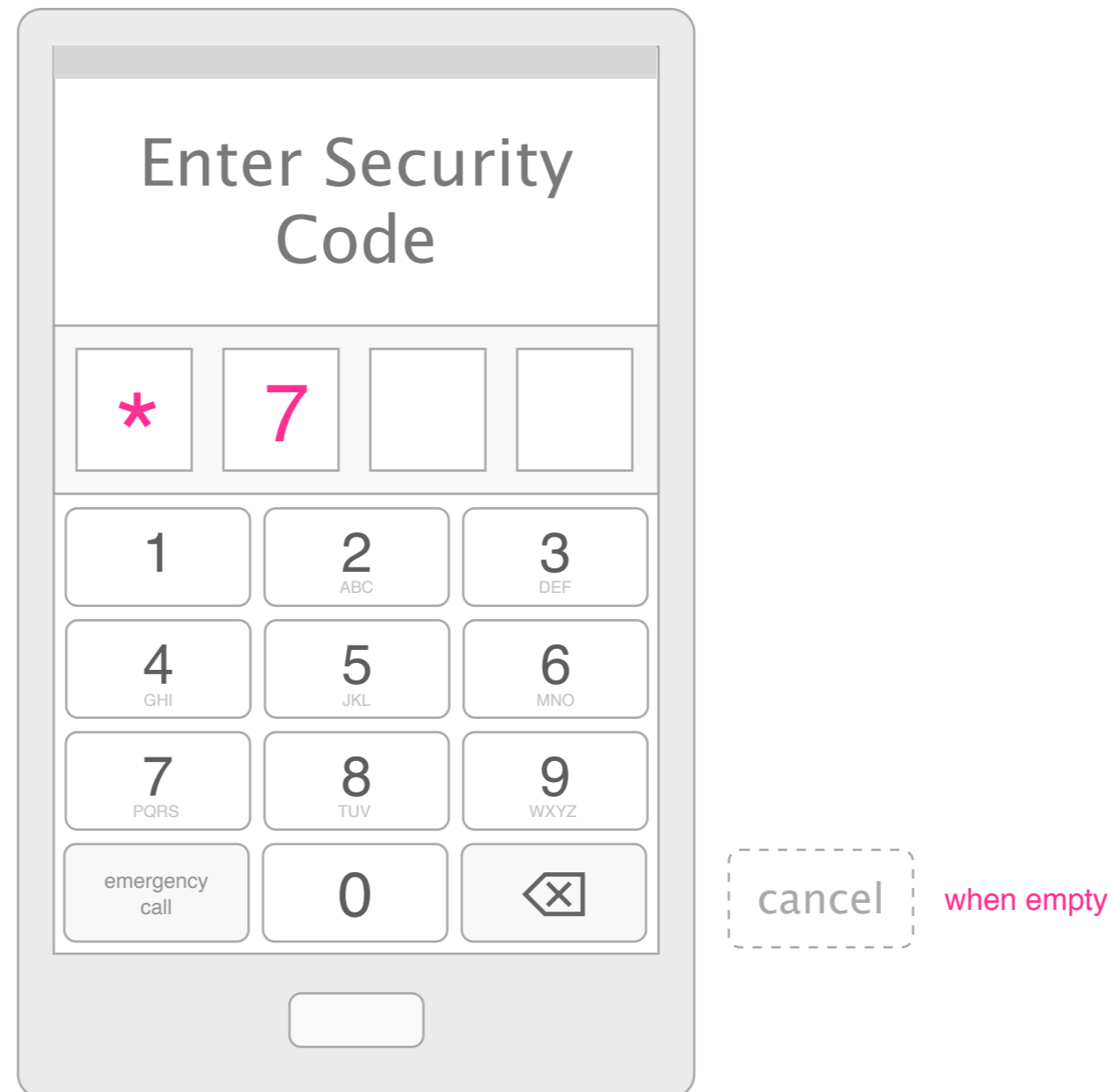

Lock Screen

Emergency Call

No keypad; just a list of common **local (even if abroad)** emergency numbers plus (optionally) one chosen by the user (mother, husband, etc.), which could be useful in mild emergencies or lost phone cases.

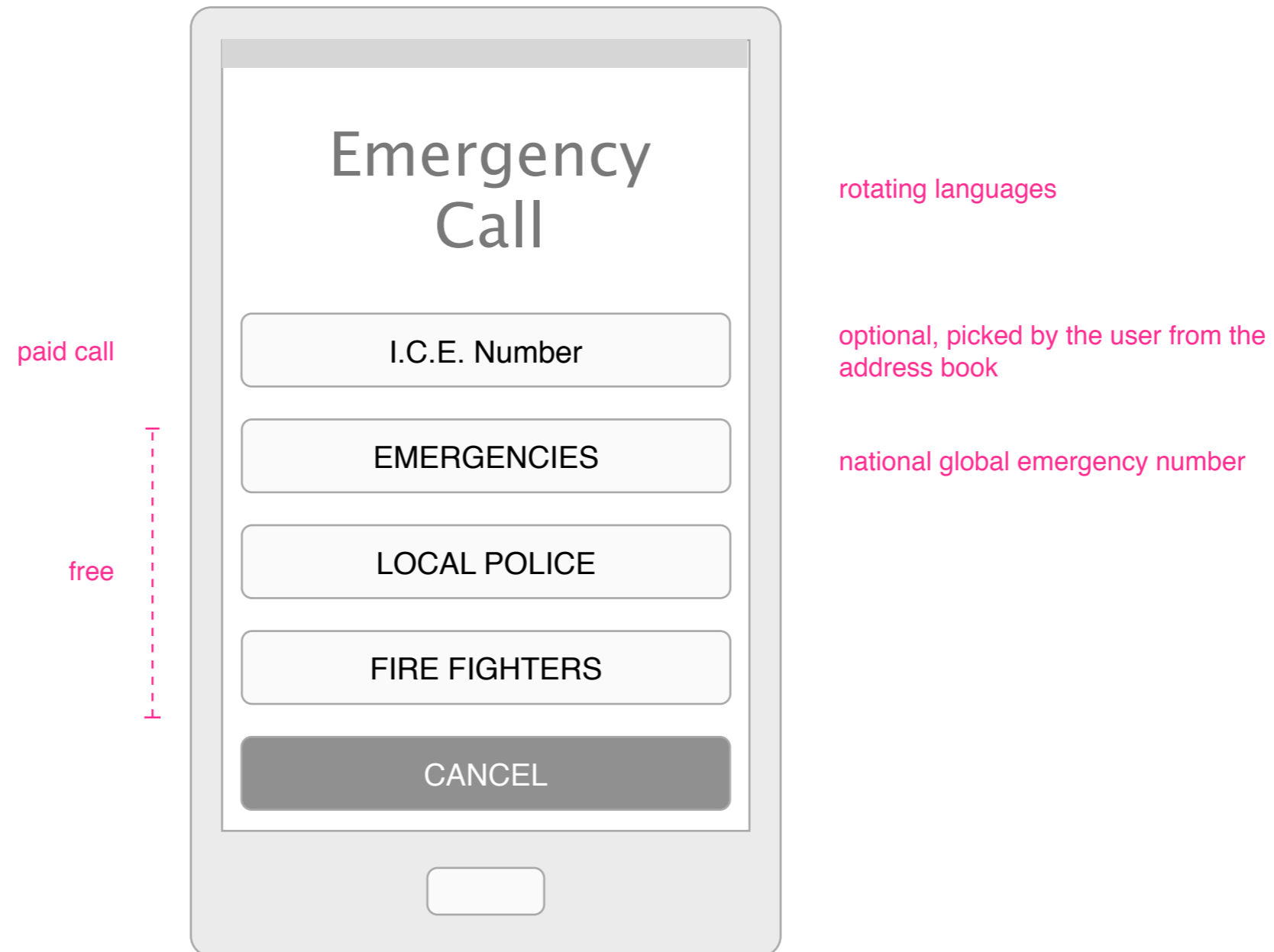

Lock Screen

Incoming Phone Call

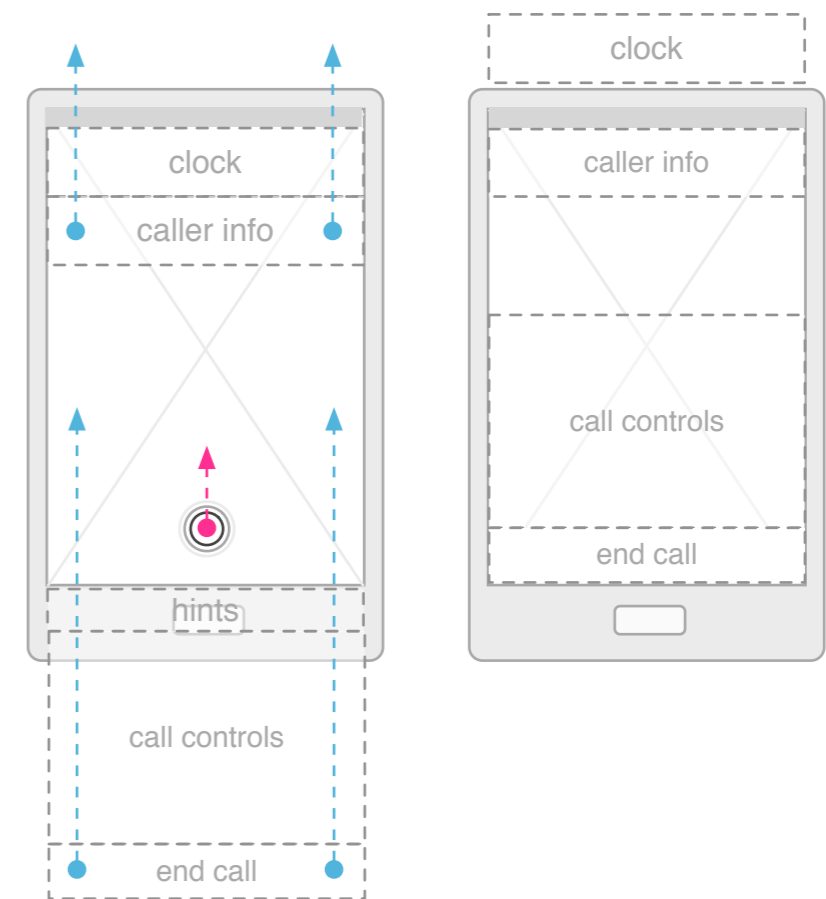
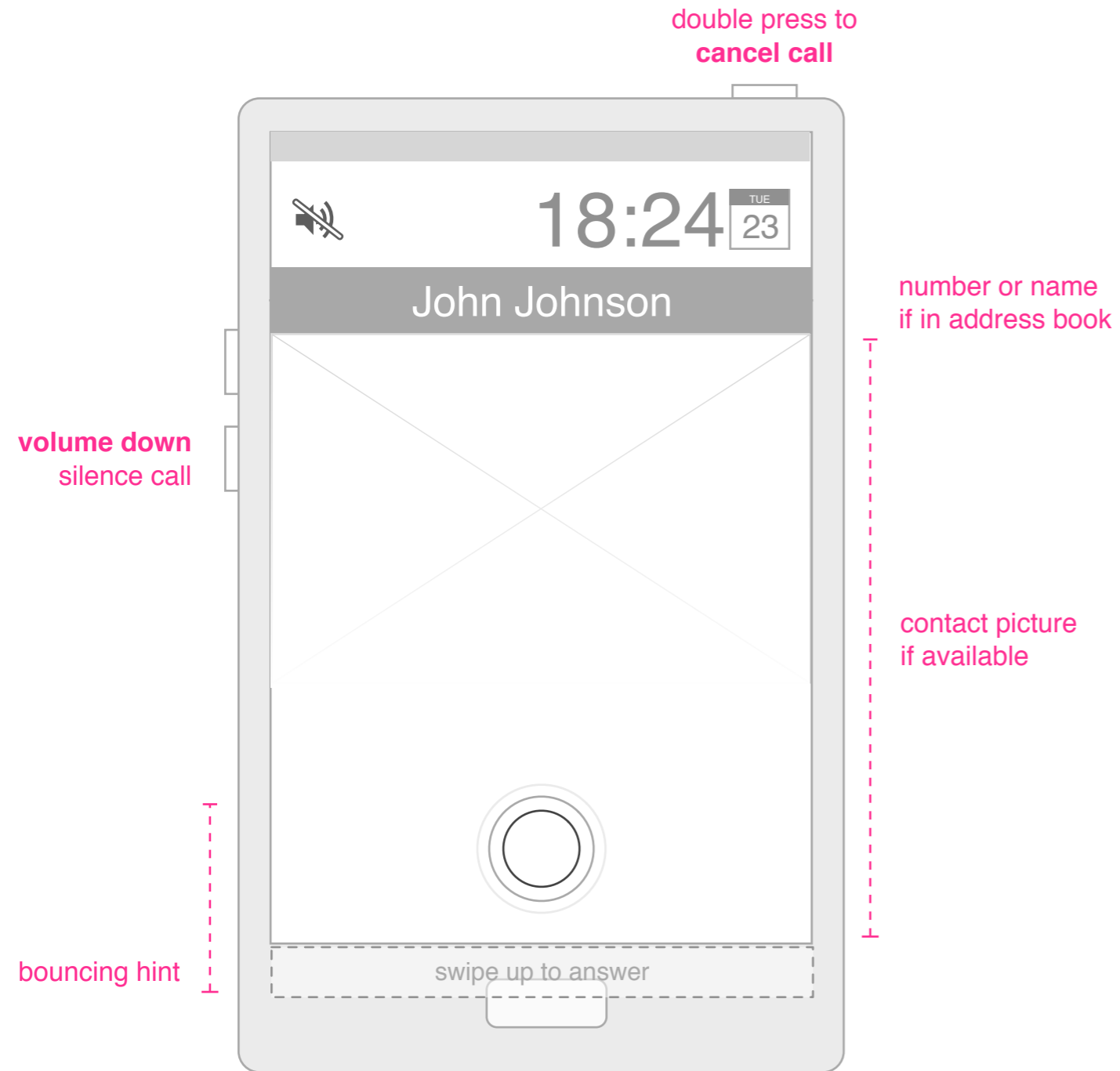

Lock Screen

Notifications

These notifications clear once the device is unlocked.

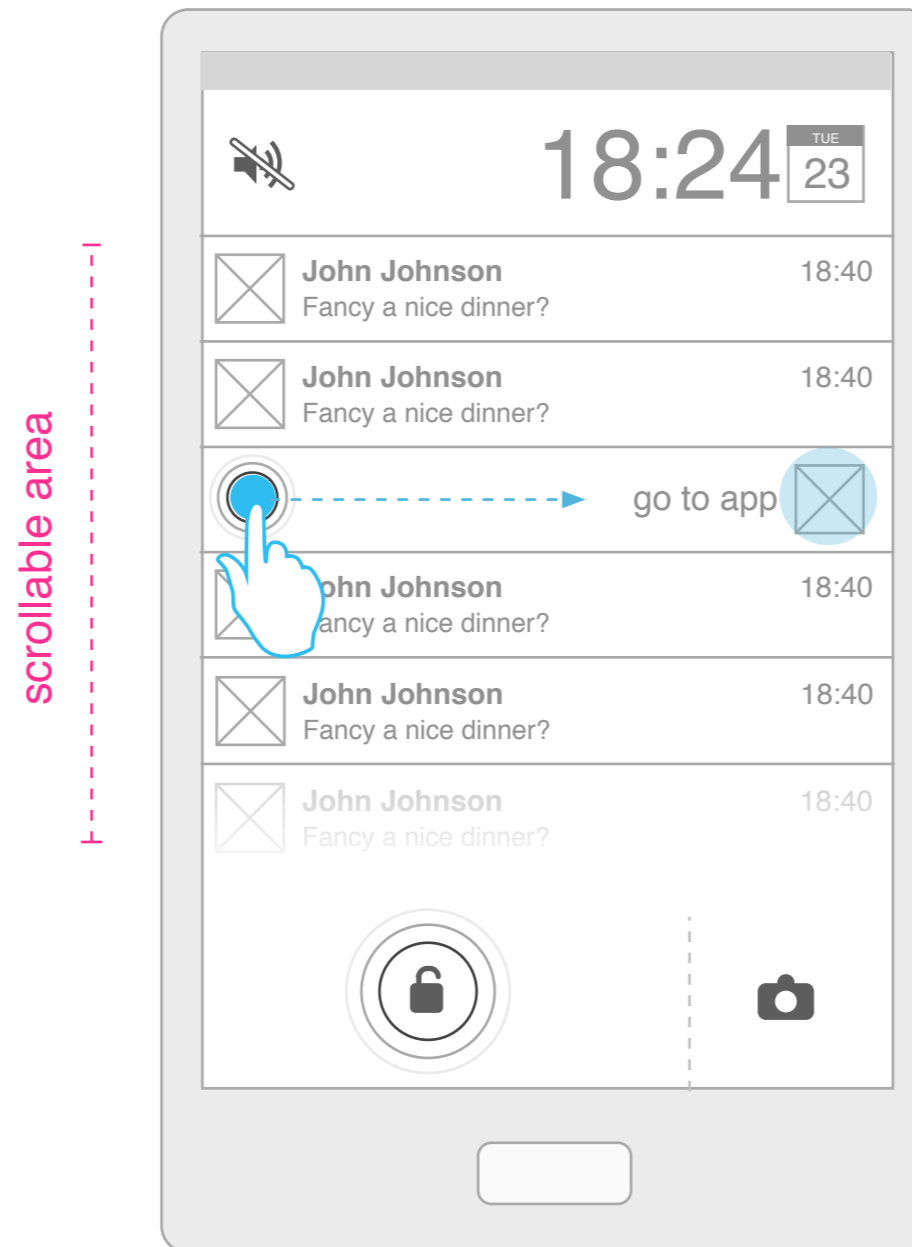

tapping a notifications allows for
unlocking via swipe

Lock Screen

Music Player Controls

Double tapping the home button while on the lock screen **toggles** between notifications and music player controls.

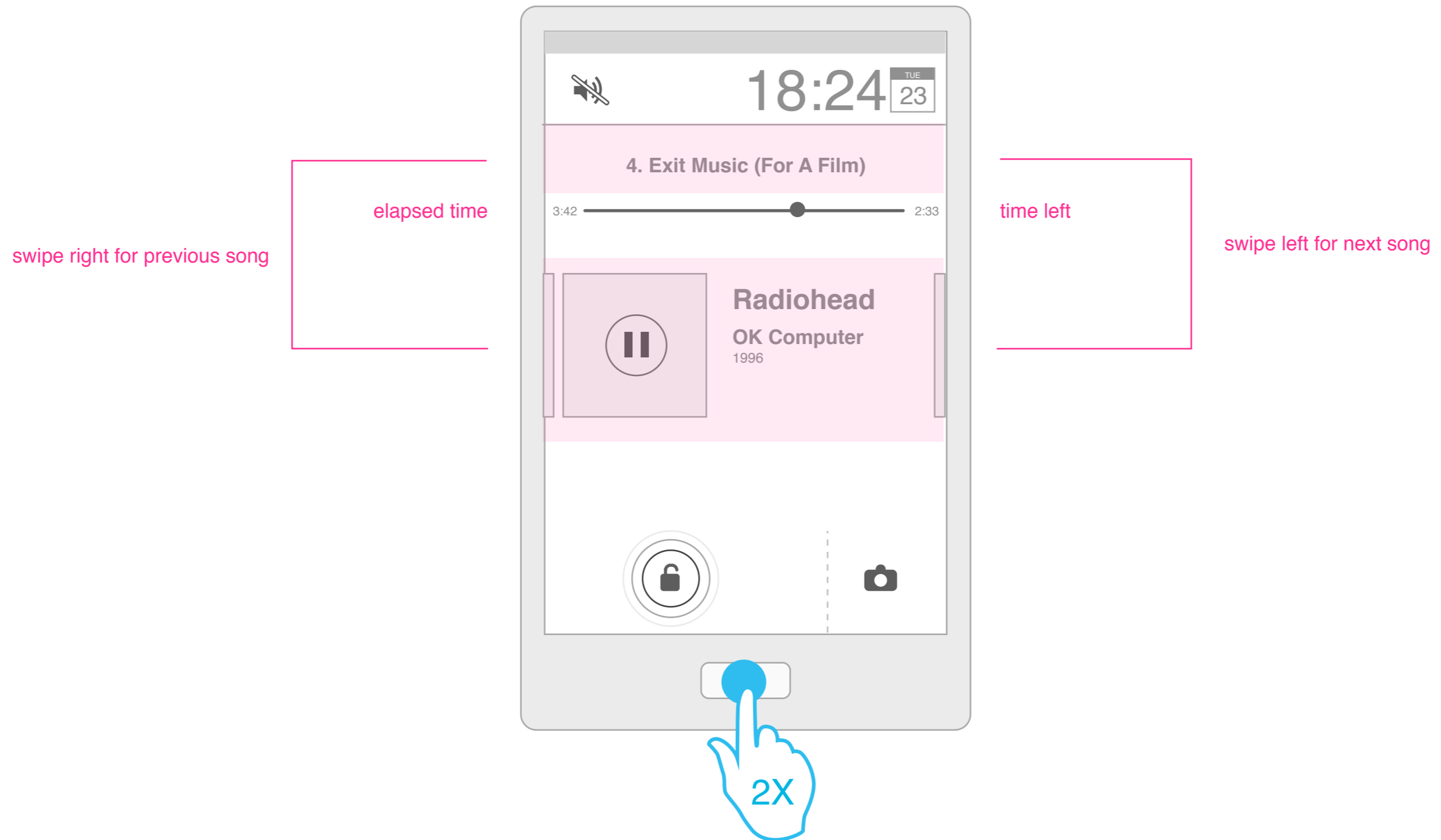

Lock Screen

Alarm

Two modes of difficulty to unlock. Maybe transition between them after a certain number of snoozes.

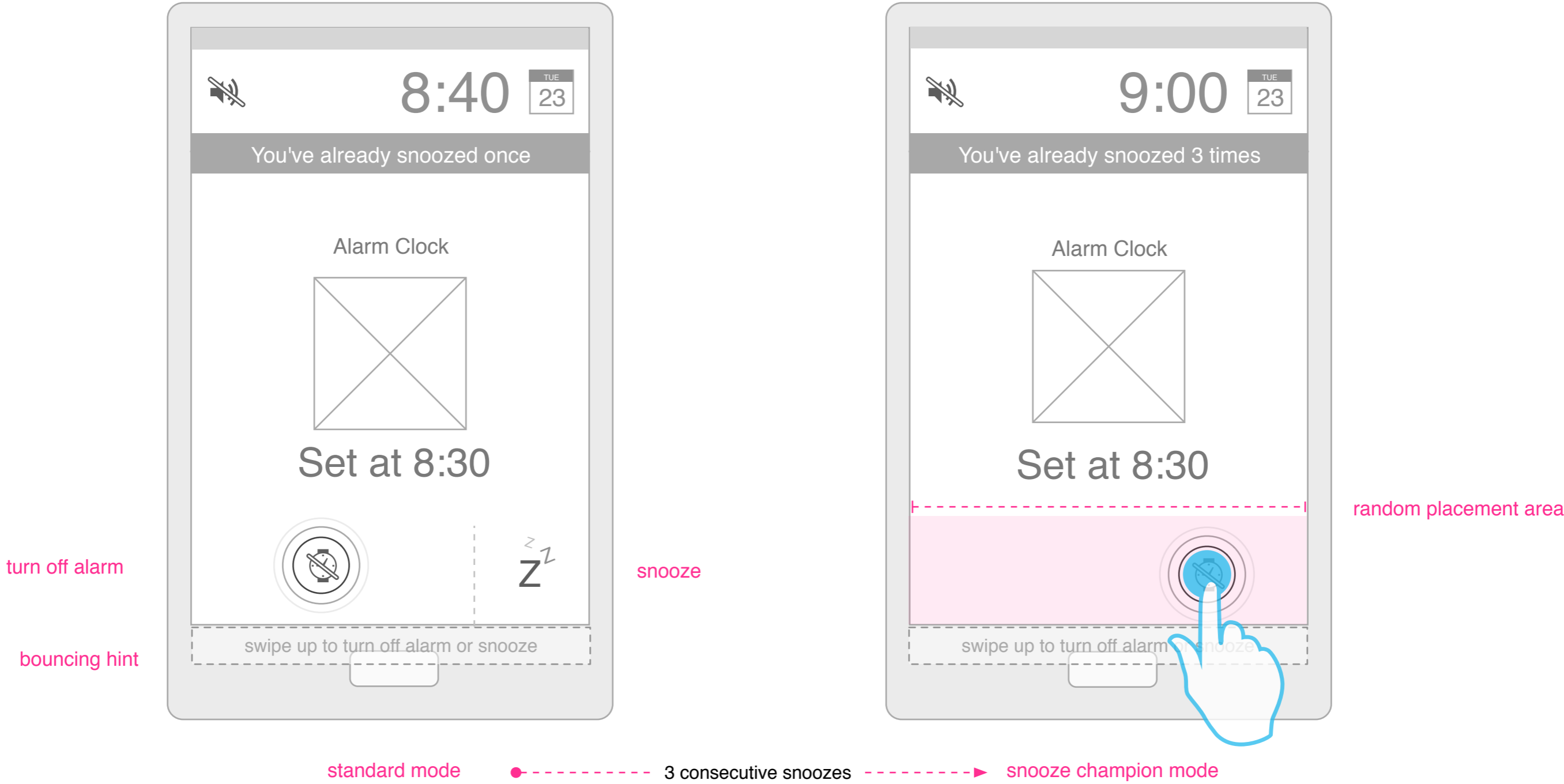

Lock Screen

Timer

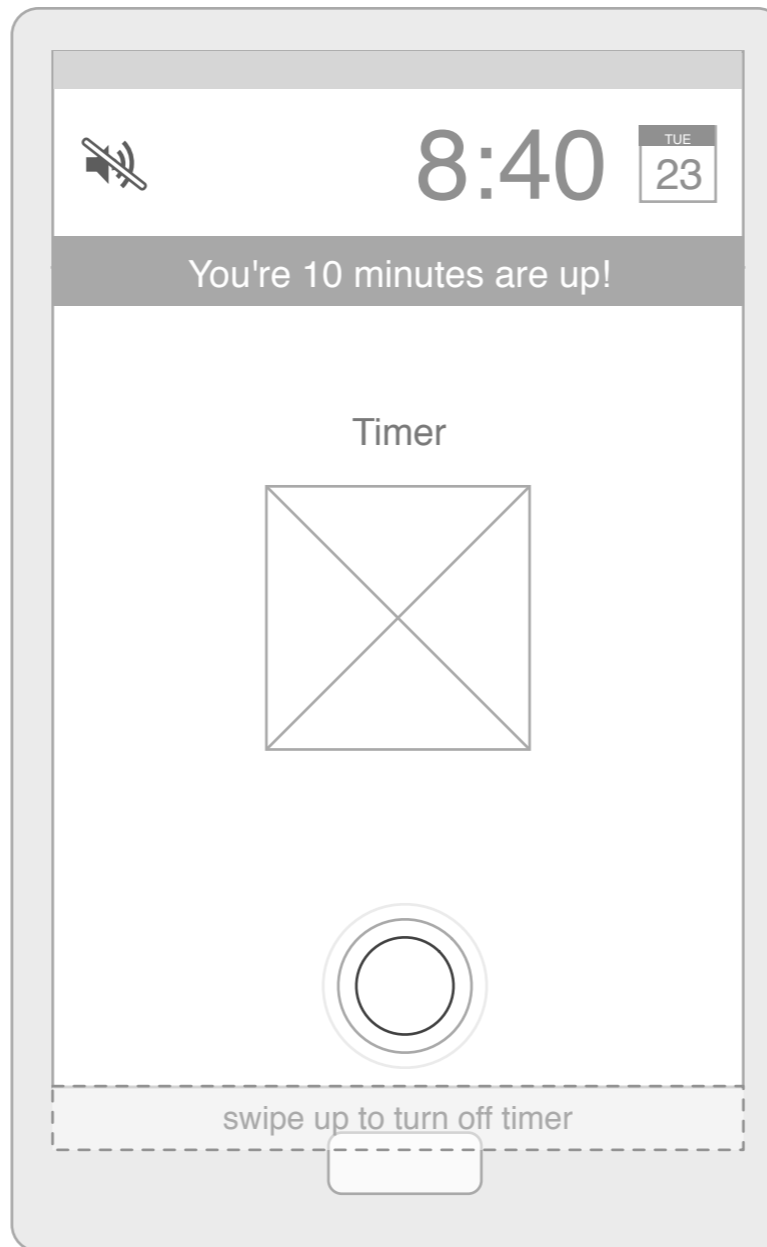

bouncing hint